

SIGN SPACING = X (1)

RURAL ROADS	45/55 MPH	500'±
URBAN ARTERIALS & RURAL ROADS	35/40 MPH	350'±
RURAL ROADS, URBAN ARTERIALS, RESIDENTIAL & BUSINESS DISTRICTS	25/30 MPH	200'± (2)
URBAN STREETS	25 MPH OR LESS	100'± (2)

ALL SIGNS ARE BLACK ON ORANGE UNLESS DESIGNATED OTHERWISE

(1) ALL SPACING MAY BE ADJUSTED TO ACCOMMODATE AT-GRADE INTERSECTIONS AND DRIVEWAYS.

(2) THIS SIGN SPACING MAY BE REDUCED IN URBAN AREAS TO FIT ROADWAY CONDITIONS.

* EXAMPLE WITH W. BADGER RD SIGN

W. BADGER RD
DETOUR
TRUCK ROUTE

PLACE BADGER RD SIGN ABOVE, TYP.

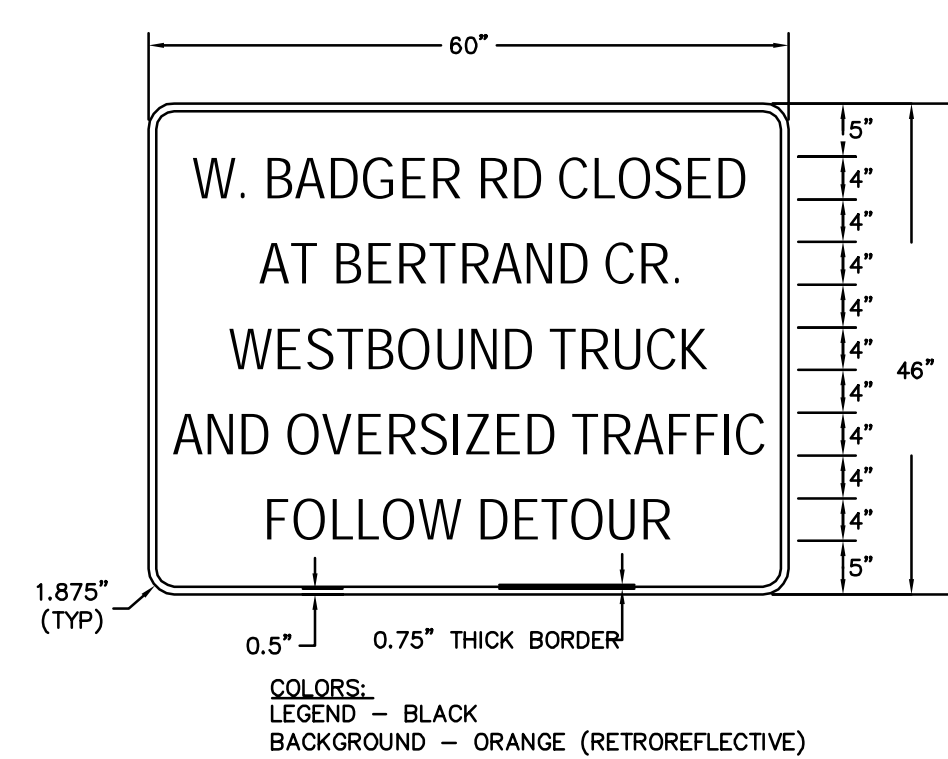

SPECIAL CONSTRUCTION SIGN
WESTBOUND TRUCK TRAFFIC
NTS

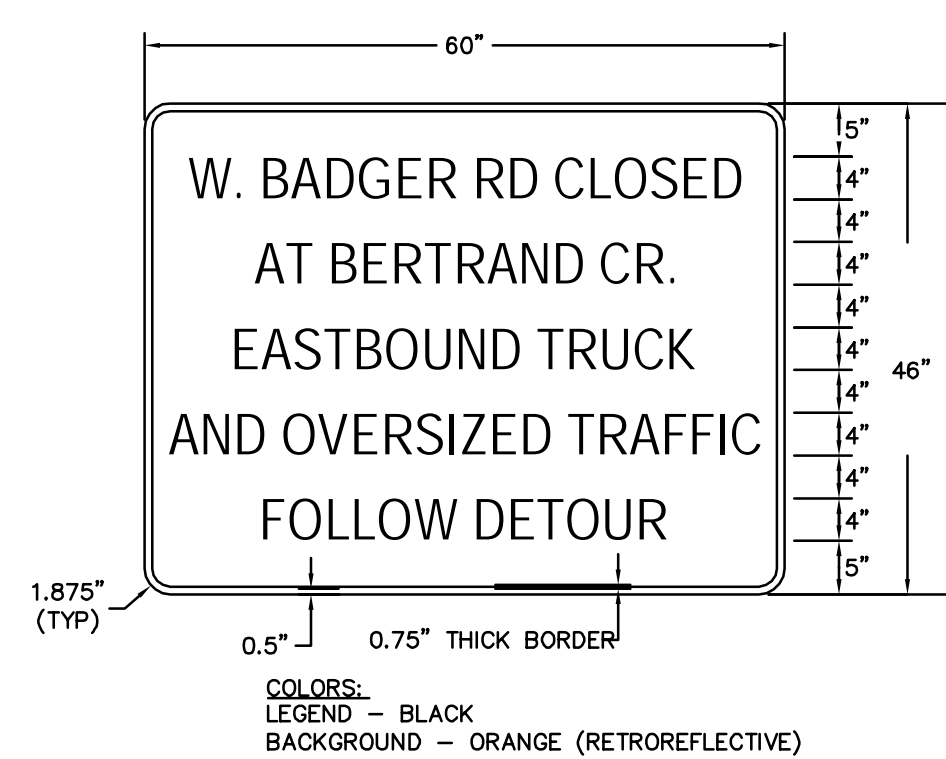

SPECIAL CONSTRUCTION SIGN
EASTBOUND TRUCK TRAFFIC
NTS

811 Know what's below.
Call before you dig.
Determina lo que esta bajo tierra.
Llama antes de excavar.

<table border="1"> <tr> <th>No.</th> <th>DATE</th> <th>BY</th> <th>ISSUED PLAN SET / REVISION</th> </tr> <tr> <td>1</td> <td></td> <td></td> <td></td> </tr> <tr> <td>2</td> <td></td> <td></td> <td></td> </tr> <tr> <td>3</td> <td></td> <td></td> <td></td> </tr> <tr> <td>4</td> <td></td> <td></td> <td></td> </tr> </table>	No.	DATE	BY	ISSUED PLAN SET / REVISION	1				2				3				4				<table border="1"> <tr> <th>DATA</th> <th>DESIGN</th> <th>DRAWN</th> <th>CHECK</th> </tr> <tr> <td>BASE:</td> <td>NJZ</td> <td>EJB</td> <td>NJZ</td> </tr> <tr> <td>PLAN:</td> <td>NJZ</td> <td>EJB</td> <td>NJZ</td> </tr> <tr> <td>HORIZ. DATUM:</td> <td colspan="3">NAD 83/91</td> </tr> <tr> <td>VERT. DATUM:</td> <td colspan="3">NAVD 88</td> </tr> </table>	DATA	DESIGN	DRAWN	CHECK	BASE:	NJZ	EJB	NJZ	PLAN:	NJZ	EJB	NJZ	HORIZ. DATUM:	NAD 83/91			VERT. DATUM:	NAVD 88			<table border="1"> <tr> <td>DATE:</td> <td>February 27, 2019</td> </tr> <tr> <td>JOB No:</td> <td>CRP 915024</td> </tr> <tr> <td>BRIDGE No:</td> <td>50</td> </tr> <tr> <td>FILE:</td> <td>16009 DETOUR.DWG</td> </tr> </table>	DATE:	February 27, 2019	JOB No:	CRP 915024	BRIDGE No:	50	FILE:	16009 DETOUR.DWG	<table border="1"> <tr> <td>PUBLIC WORKS DIRECTOR:</td> <td>JON HUTCHINGS</td> </tr> <tr> <td>COUNTY ENGINEER:</td> <td>JOSEPH P. RUTAN, P.E.</td> </tr> <tr> <td>PROJECT ENGINEER:</td> <td>JAMES E. LEE, P.E.</td> </tr> </table>	PUBLIC WORKS DIRECTOR:	JON HUTCHINGS	COUNTY ENGINEER:	JOSEPH P. RUTAN, P.E.	PROJECT ENGINEER:	JAMES E. LEE, P.E.		<p>WHATCOM COUNTY DEPARTMENT OF PUBLIC WORKS 322 N. COMMERCIAL ST., SUITE 301 BELLINGHAM, WA 98225 (360) 778-6210</p>	<table border="1"> <tr> <td>PROJECT:</td> <td>WEST BADGER ROAD / BERTRAND CREEK BRIDGE NO. 50 REPLACEMENT</td> </tr> <tr> <td>TITLE:</td> <td>TRUCK DETOUR</td> </tr> </table>	PROJECT:	WEST BADGER ROAD / BERTRAND CREEK BRIDGE NO. 50 REPLACEMENT	TITLE:	TRUCK DETOUR	<table border="1"> <tr> <td>SHEET:</td> <td>C9</td> </tr> <tr> <td>OF:</td> <td>9 of 42</td> </tr> </table>	SHEET:	C9	OF:	9 of 42
No.	DATE	BY	ISSUED PLAN SET / REVISION																																																																		
1																																																																					
2																																																																					
3																																																																					
4																																																																					
DATA	DESIGN	DRAWN	CHECK																																																																		
BASE:	NJZ	EJB	NJZ																																																																		
PLAN:	NJZ	EJB	NJZ																																																																		
HORIZ. DATUM:	NAD 83/91																																																																				
VERT. DATUM:	NAVD 88																																																																				
DATE:	February 27, 2019																																																																				
JOB No:	CRP 915024																																																																				
BRIDGE No:	50																																																																				
FILE:	16009 DETOUR.DWG																																																																				
PUBLIC WORKS DIRECTOR:	JON HUTCHINGS																																																																				
COUNTY ENGINEER:	JOSEPH P. RUTAN, P.E.																																																																				
PROJECT ENGINEER:	JAMES E. LEE, P.E.																																																																				
PROJECT:	WEST BADGER ROAD / BERTRAND CREEK BRIDGE NO. 50 REPLACEMENT																																																																				
TITLE:	TRUCK DETOUR																																																																				
SHEET:	C9																																																																				
OF:	9 of 42																																																																				

P:\Projects\16009_16_Civil\2019\16009 DETOUR.dwg, 9 TRUCK DETOUR, 2/28/19 10:52 AM

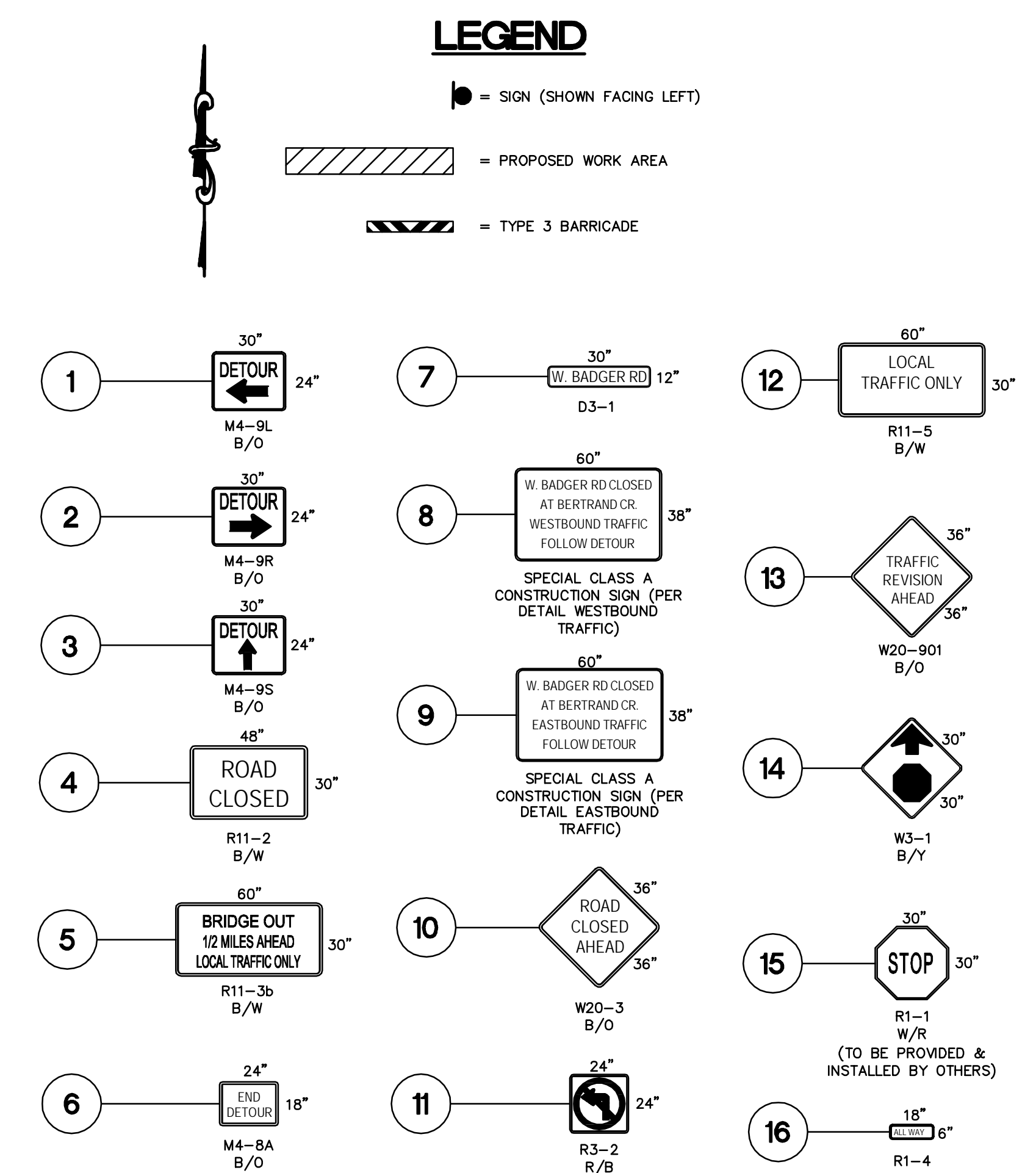
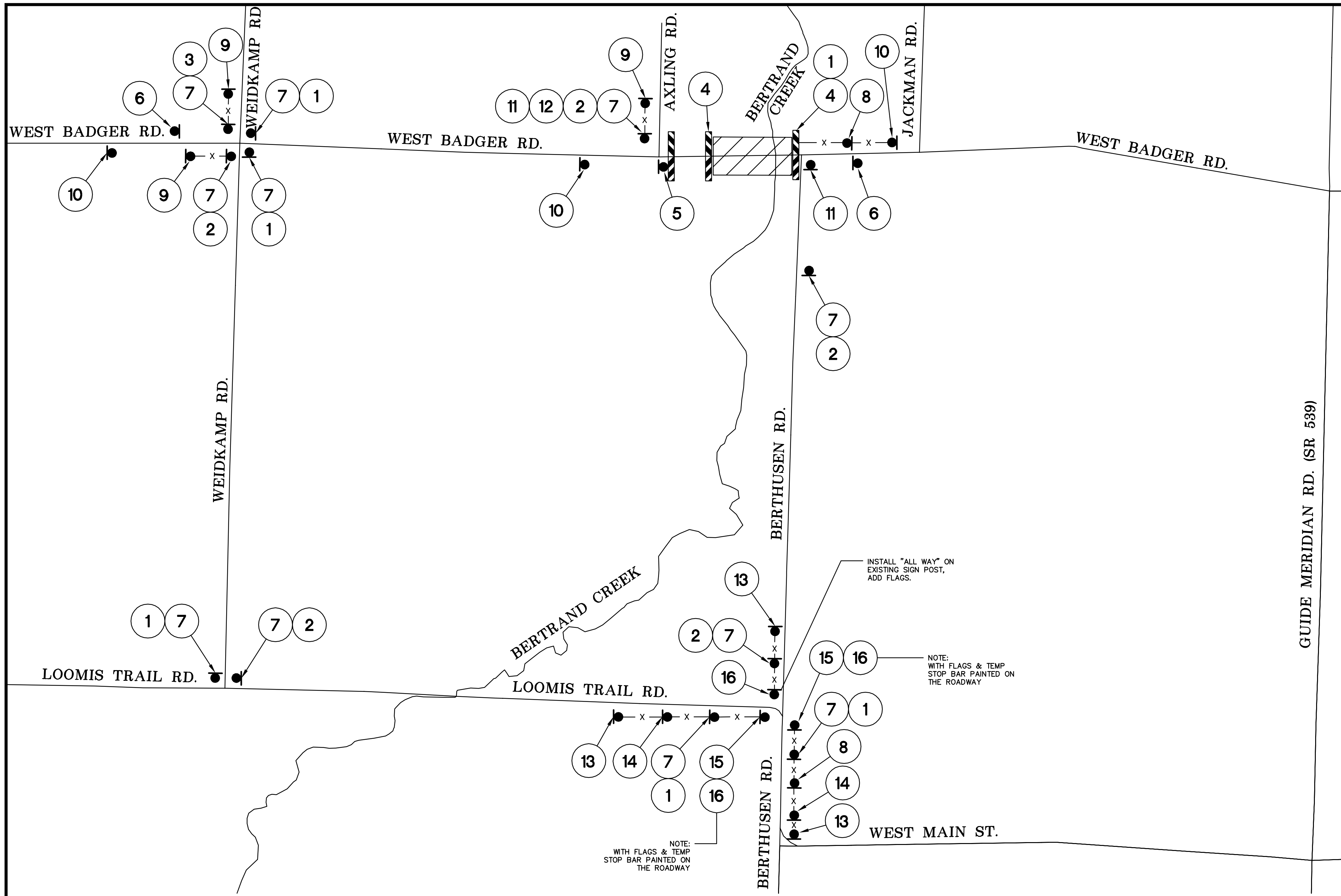

INSTALL "ALL WAY" ON EXISTING SIGN POST, ADD FLAGS.

NOTE: WITH FLAGS & TEMP STOP BAR PAINTED ON THE ROADWAY

NOTE: WITH FLAGS & TEMP STOP BAR PAINTED ON THE ROADWAY

SIGN SPACING = X (1)

RURAL ROADS	45/55 MPH
URBAN ARTERIALS & RURAL ROADS	35/40 MPH
RURAL ROADS, URBAN ARTERIALS, RESIDENTIAL & BUSINESS DISTRICTS	25/30 MPH
URBAN STREETS	25 MPH OR LESS

ALL SIGNS ARE BLACK ON ORANGE UNLESS DESIGNATED OTHERWISE

* EXAMPLE WITH W. BADGER RD SIGN

PLACE BADGER RD SIGN ABOVE, TYP.

(1) ALL SPACING MAY BE ADJUSTED TO ACCOMMODATE AT-GRADE INTERSECTIONS AND DRIVEWAYS.

(2) THIS SIGN SPACING MAY BE REDUCED IN URBAN AREAS TO FIT ROADWAY CONDITIONS.

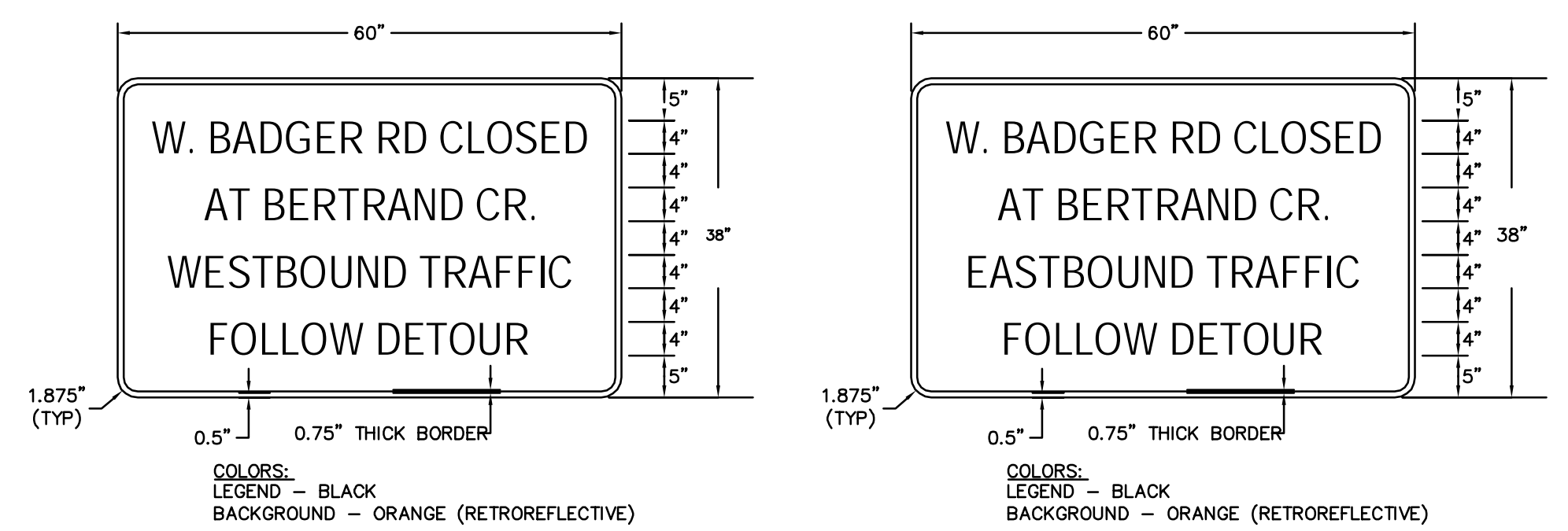

SPECIAL CONSTRUCTION SIGN WESTBOUND TRAFFIC
NTS

SPECIAL CONSTRUCTION SIGN EASTBOUND TRAFFIC
NTS

811 Know what's below. Call before you dig.
Determina lo que esta bajo tierra. Llama antes de excavar.

No.	DATE	BY	ISSUED PLAN SET / REVISION
1			
2			
3			
4			

DATA	DESIGN	DRAWN	CHECK
BASE: NJZ	NJZ	EJB	NJZ
PLAN: NJZ	NJZ	EJB	NJZ
HORIZ. DATUM: NAD 83/91			
VERT. DATUM: NAVD 88			

DATE: February 27, 2019
JOB No: CRP 915024
BRIDGE No: 50
FILE: 16009 DETOUR.DWG

PUBLIC WORKS DIRECTOR: JON HUTCHINGS
COUNTY ENGINEER: JOSEPH P. RUTAN, P.E.
PROJECT ENGINEER: JAMES E. LEE, P.E.

R&E Reichhardt & Ebe
ENGINEERING INC

WHATCOM COUNTY
DEPARTMENT OF PUBLIC WORKS
322 N. COMMERCIAL ST., SUITE 301 BELLINGHAM, WA 98225
(360) 778-6210

PROJECT: WEST BADGER ROAD / BERTRAND CREEK BRIDGE NO. 50 REPLACEMENT PASSENGER CAR DETOUR
TITLE:

SHEET: C10
OF: 10 of 42

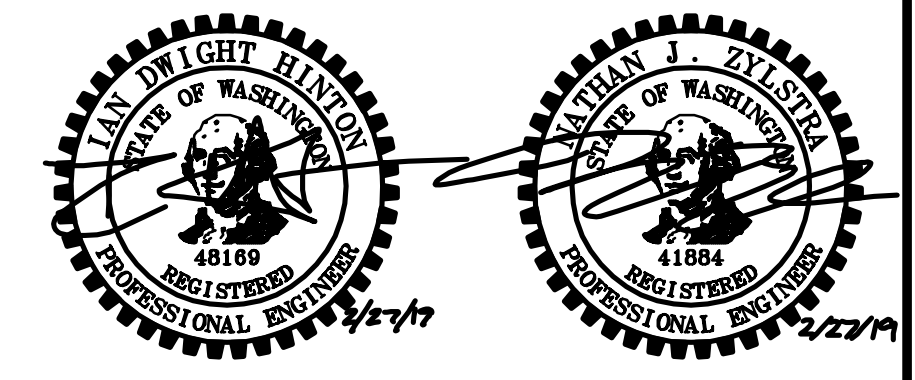

P:\Projects\16009_16_Civil\3D_2019\16009 DETOUR.dwg, 10 PASSENGER CAR DETOUR, 2/28/2019 10:44 AM